

- Matched Address:**  
MSA: || State: || County: || Tract Code:
- Selected Tract**  
MSA: || State: || County: || Tract Code:

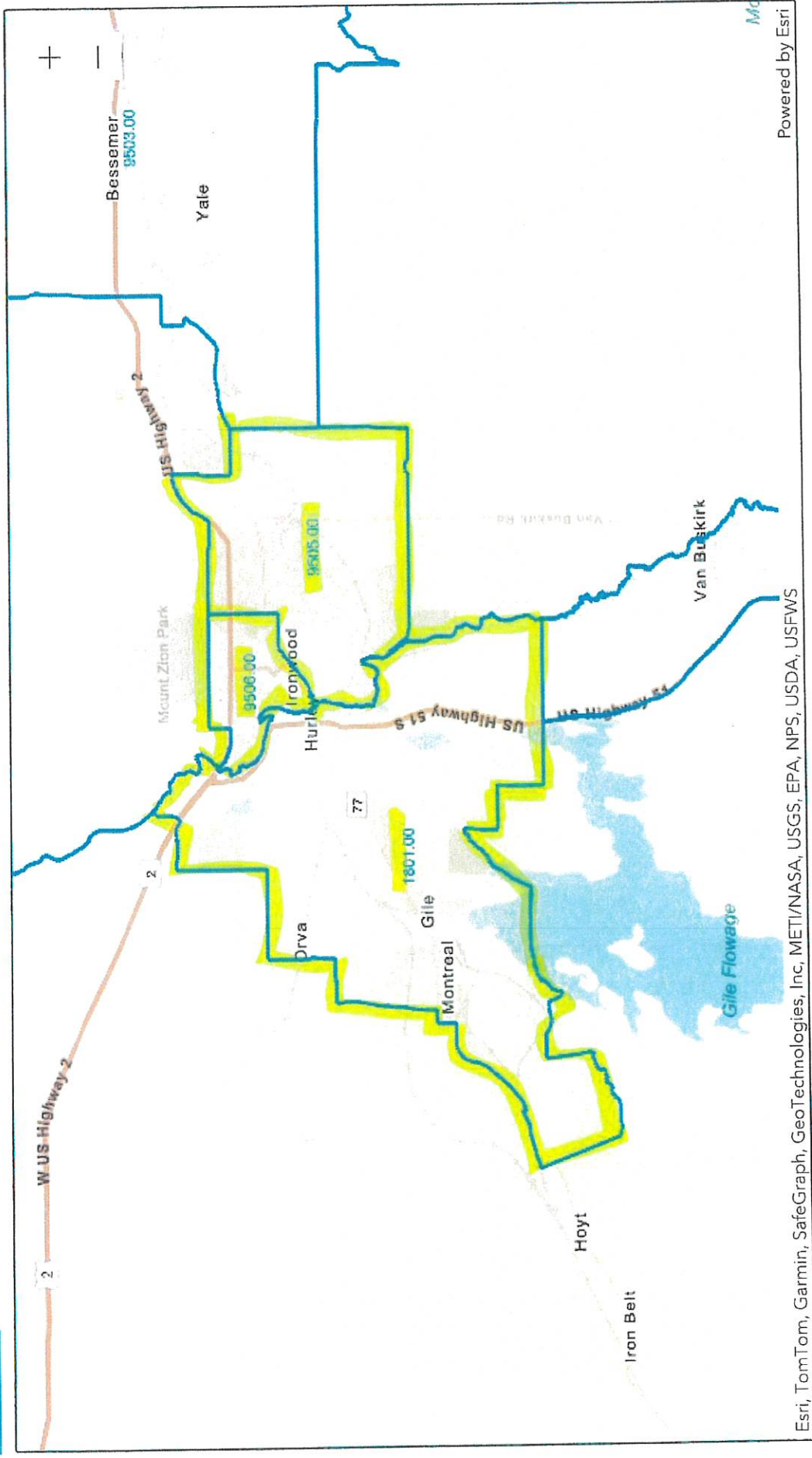

Esri, TomTom, Garmin, SafeGraph, GeoTechnologies, Inc, METI/NASA, USGS, EPA, NPS, USDA, USFWS

- Matched Address:  
MSA: || State: || County: || Tract Code:
- Selected Tract  
MSA: || State: || County: || Tract Code:

**GOGEBIC  
COUNTY,  
MICHIGAN**

# Gogebic County, Michigan

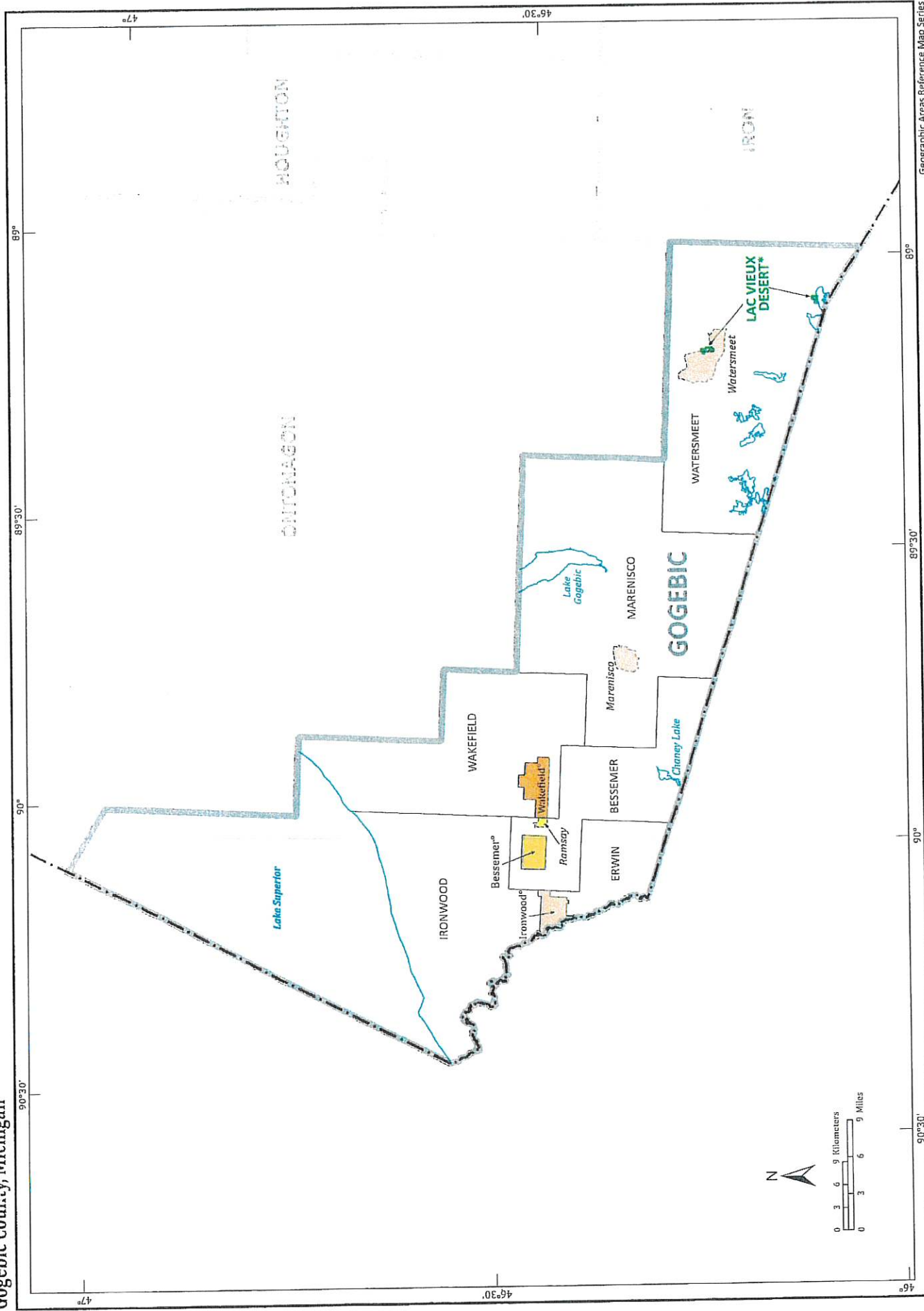

2020 CENSUS - CENSUS TRACT REFERENCE MAP: Gagebic County, MI

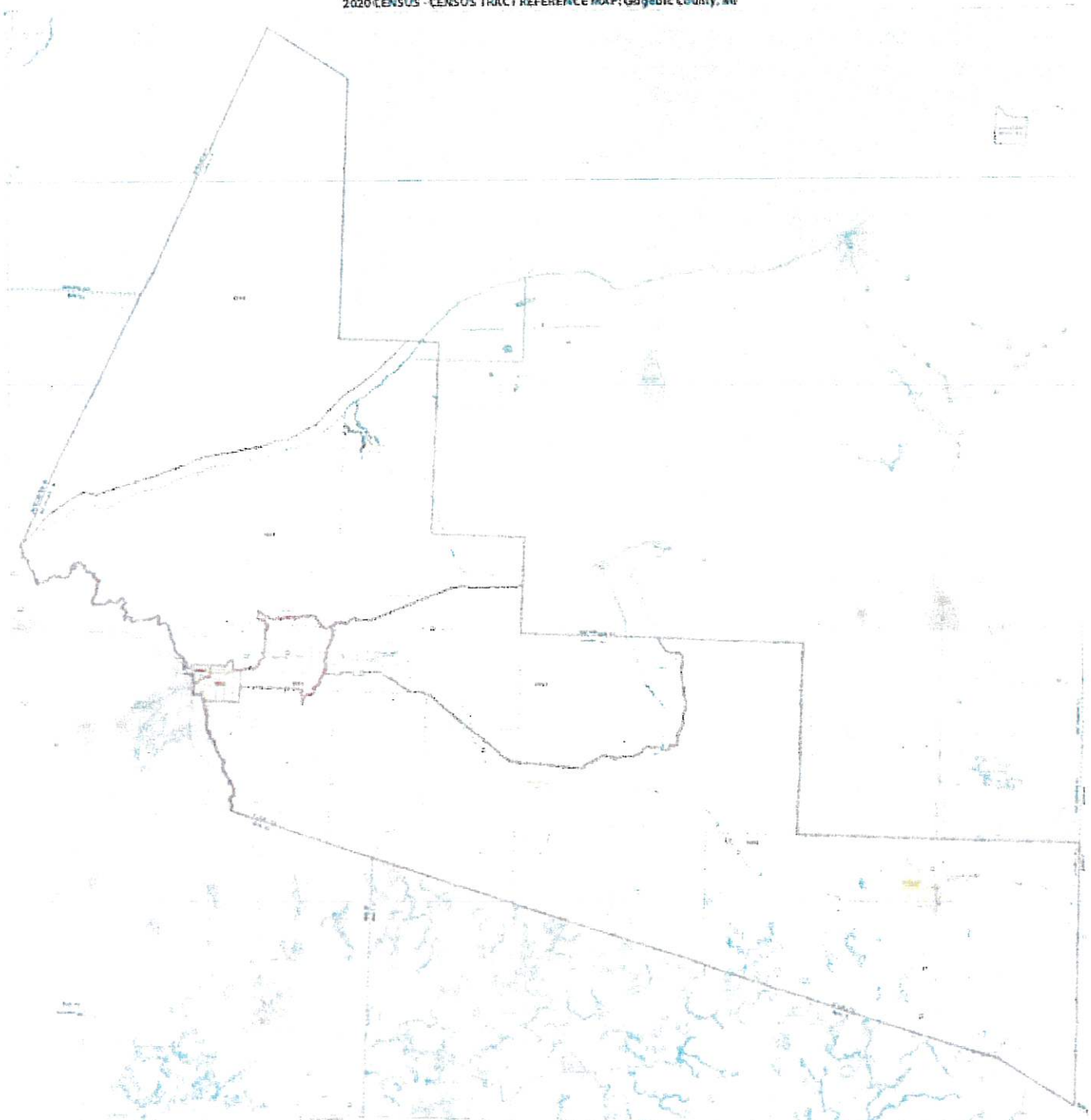

TRACT	POPULATION	AREA	POP. DENSITY
1000	1000	1000	1000
1001	1000	1000	1000
1002	1000	1000	1000
1003	1000	1000	1000
1004	1000	1000	1000
1005	1000	1000	1000
1006	1000	1000	1000
1007	1000	1000	1000
1008	1000	1000	1000
1009	1000	1000	1000
1010	1000	1000	1000
1011	1000	1000	1000
1012	1000	1000	1000
1013	1000	1000	1000
1014	1000	1000	1000
1015	1000	1000	1000
1016	1000	1000	1000
1017	1000	1000	1000
1018	1000	1000	1000
1019	1000	1000	1000
1020	1000	1000	1000
1021	1000	1000	1000
1022	1000	1000	1000
1023	1000	1000	1000
1024	1000	1000	1000
1025	1000	1000	1000
1026	1000	1000	1000
1027	1000	1000	1000
1028	1000	1000	1000
1029	1000	1000	1000
1030	1000	1000	1000
1031	1000	1000	1000
1032	1000	1000	1000
1033	1000	1000	1000
1034	1000	1000	1000
1035	1000	1000	1000
1036	1000	1000	1000
1037	1000	1000	1000
1038	1000	1000	1000
1039	1000	1000	1000
1040	1000	1000	1000
1041	1000	1000	1000
1042	1000	1000	1000
1043	1000	1000	1000
1044	1000	1000	1000
1045	1000	1000	1000
1046	1000	1000	1000
1047	1000	1000	1000
1048	1000	1000	1000
1049	1000	1000	1000
1050	1000	1000	1000
1051	1000	1000	1000
1052	1000	1000	1000
1053	1000	1000	1000
1054	1000	1000	1000
1055	1000	1000	1000
1056	1000	1000	1000
1057	1000	1000	1000
1058	1000	1000	1000
1059	1000	1000	1000
1060	1000	1000	1000
1061	1000	1000	1000
1062	1000	1000	1000
1063	1000	1000	1000
1064	1000	1000	1000
1065	1000	1000	1000
1066	1000	1000	1000
1067	1000	1000	1000
1068	1000	1000	1000
1069	1000	1000	1000
1070	1000	1000	1000
1071	1000	1000	1000
1072	1000	1000	1000
1073	1000	1000	1000
1074	1000	1000	1000
1075	1000	1000	1000
1076	1000	1000	1000
1077	1000	1000	1000
1078	1000	1000	1000
1079	1000	1000	1000
1080	1000	1000	1000
1081	1000	1000	1000
1082	1000	1000	1000
1083	1000	1000	1000
1084	1000	1000	1000
1085	1000	1000	1000
1086	1000	1000	1000
1087	1000	1000	1000
1088	1000	1000	1000
1089	1000	1000	1000
1090	1000	1000	1000
1091	1000	1000	1000
1092	1000	1000	1000
1093	1000	1000	1000
1094	1000	1000	1000
1095	1000	1000	1000
1096	1000	1000	1000
1097	1000	1000	1000
1098	1000	1000	1000
1099	1000	1000	1000

Information regarding the map's accuracy and data sources. This section typically includes a disclaimer about the map's use and a note on the date of the data.

Additional text or notes located at the bottom of the map, possibly providing contact information or further details about the map's creation.

Map scale and projection information, including the scale in feet and the map's coordinate system.



TYPE;FULLCODE;STATE;COUNTY;TRACT;SHEETS

TRACT;26053950200;26;053;9502.00;1

TRACT;26053950300;26;053;9503.00;1

TRACT;26053950500;26;053;9505.00;1

TRACT;26053950600;26;053;9506.00;1

TRACT;26053950700;26;053;9507.00;1

TRACT;26053950800;26;053;9508.00;1

TRACT;26053990000;26;053;9900.00;1

2023 FFIEC Census Report - Summary Census Demographic Information

State: 26 - MICHIGAN (MI)

County: 053 - GOGEBIC COUNTY

Tract: All Tracts



State Code	County Code	Tract Code	Tract Income Level	Distressed or Underserved Tract	Tract Median Family Income %	2023 FFIEC Est. MSA/MD non-MSA/MD Median Family Income	2023 Est. Tract Median Family Income	2020 Tract Median Family Income	Tract Population	Tract Minority %	Minority Population	Owner Occupied Units	1- to 4- Family Units
26	053	9502.00	Middle	Yes*	81.40	\$79,800	\$64,957	\$52,885	2312	5.23	121	890	1606
26	053	9503.00	Middle	Yes*	102.85	\$79,800	\$82,074	\$66,818	2313	7.39	171	900	1431
26	053	9505.00	Moderate	No	72.54	\$79,800	\$57,887	\$47,132	2272	8.89	202	808	1094
26	053	9506.00	Moderate	No	60.56	\$79,800	\$48,327	\$39,347	2772	9.13	253	914	1549
26	053	9507.00	Middle	Yes*	101.97	\$79,800	\$81,372	\$66,250	2253	5.28	119	902	1663
26	053	9508.00	Middle	Yes*	95.24	\$79,800	\$76,002	\$61,875	2458	21.68	533	934	2653
26	053	9900.00	Unknown	No	0.00	\$79,800	\$0	\$0	0	0.00	0	0	0
26	053	9999.99	Middle	No	88.64	\$79,800	\$70,735	\$57,591	14380	9.73	1399	5348	9996

\* Will automatically be included in the 2024 Distressed or Underserved Tract List

2023 FFIEC Census Report - Summary Census Income Information

State: 26 - MICHIGAN (MI)

County: 053 - GOGEBIC COUNTY



State Code	County Code	Tract Code	Tract Income Level	2020 MSA/MD Statewide non-MSA/MD Median Family Income	2023 FFIEC Est. MSA/MD non-MSA/MD Median Family Income	% Below Poverty Line	Tract Median Family Income %	2020 Tract Median Family Income	2023 Est. Tract Median Family Income	2020 Tract Median Household Income
26	053	9502.00	Middle	\$64,965	\$79,800	20.75	81.40	\$52,885	\$64,957	\$36,604
26	053	9503.00	Middle	\$64,965	\$79,800	15.98	102.85	\$66,818	\$82,074	\$44,808
26	053	9505.00	Moderate	\$64,965	\$79,800	16.75	72.54	\$47,132	\$57,887	\$25,554
26	053	9506.00	Moderate	\$64,965	\$79,800	15.04	60.56	\$39,347	\$48,327	\$30,705
26	053	9507.00	Middle	\$64,965	\$79,800	11.58	101.97	\$66,250	\$81,372	\$59,570
26	053	9508.00	Middle	\$64,965	\$79,800	11.41	95.24	\$61,875	\$76,002	\$46,081
26	053	9900.00	Unknown	\$64,965	\$79,800	0.00	0.00	\$0	\$0	\$0
26	053	9999.99	Middle	\$64,965	\$79,800	15.24	88.64	\$57,591	\$70,735	\$38,625



2023 FFIEC Census Report - Summary Census Population Information

State: 26 - MICHIGAN (MI)

County: 053 - GOGEBIC COUNTY

Tract: All Tracts



State Code	County Code	Tract Code	Tract Population	Tract Minority %	Number of Families	Number of Households	Non-Hisp White Population	Tract Minority Population	American Indian Population	Asian/Hawaiian/Pacific Islander Population	Black Population	Hispanic Population	Other Population/Two or More Races
26	053	9502.00	2312	5.23	576	1068	2191	121	9	6	4	26	76
26	053	9503.00	2313	7.39	688	1100	2142	171	19	5	5	36	106
26	053	9505.00	2272	8.89	457	1191	2070	202	30	6	14	49	103
26	053	9506.00	2772	9.13	725	1419	2519	253	33	14	30	54	122
26	053	9507.00	2253	5.28	651	1041	2134	119	15	3	11	27	63
26	053	9508.00	2458	21.68	650	1077	1925	533	406	4	1	30	92
26	053	9900.00	0	0.00	0	0	0	0	0	0	0	0	0
26	053	9999.99	14380	9.73	3747	6896	12981	1399	512	38	65	222	562

2023 FFIEC Census Report - Summary Census Housing Information

State: 26 - MICHIGAN (MI)

County: 053 - GOGEBIC COUNTY

Tract: All Tracts



State Code	County Code	Tract Code	Total Housing Units	1- to 4- Family Units	Median House Age (Years)	Inside Principal City?	Owner Occupied Units	Vacant Units	Owner Occupied 1- to 4- Family Units	Renter Occupied Units
26	053	9502.00	1665	1606	71	No	890	597	887	178
26	053	9503.00	1592	1431	67	No	900	492	885	200
26	053	9505.00	1389	1094	0	No	808	198	803	383
26	053	9506.00	1726	1549	0	No	914	307	914	505
26	053	9507.00	1749	1663	49	No	902	708	902	139
26	053	9508.00	2658	2653	42	No	934	1581	934	143
26	053	9900.00	0	0	0	No	0	0	0	0
26	053	9999.99	10779	9996	65	No	5348	3883	5325	1548

**ONTONAGON  
COUNTY,  
MICHIGAN**

Ontonagon County, Michigan

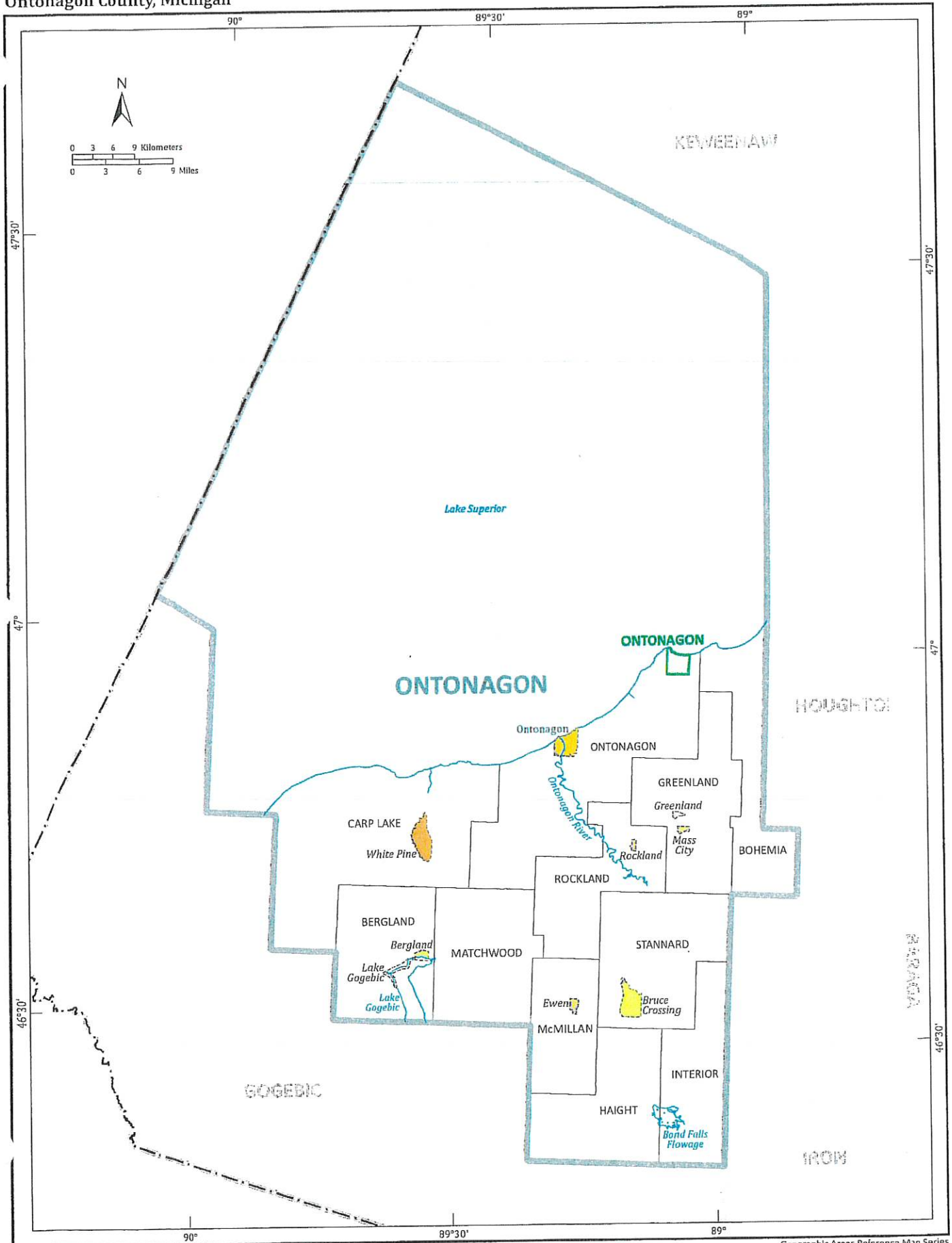

2020 CENSUS - CENSUS TRACT REFERENCE MAP: Ontonagon County, MI

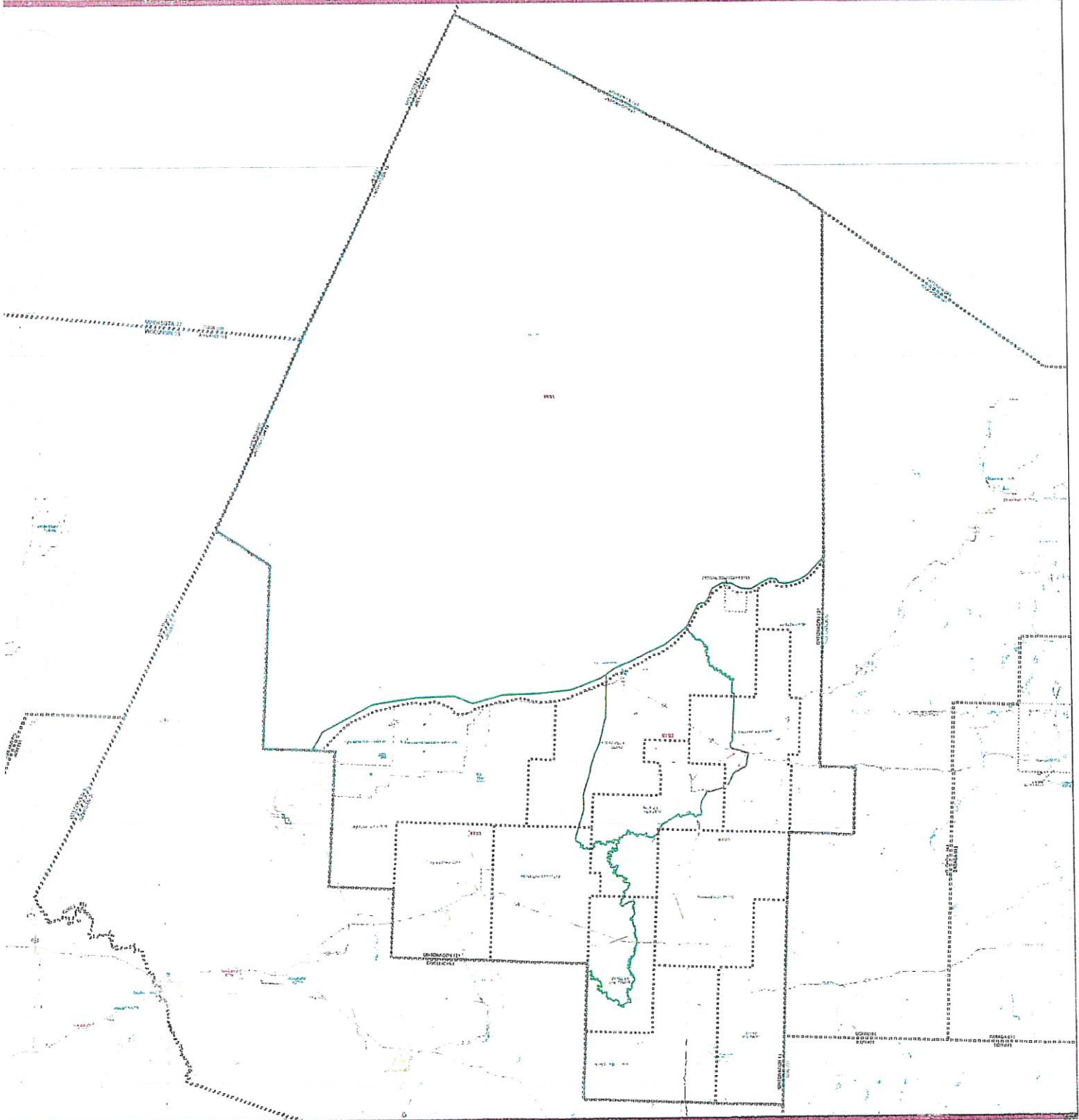

Tract	County	State	Year	Population	Area (sq. mi.)	Population Density (per sq. mi.)
4800000	ONTONAGON	MI	2020	1,123	1,123	1
4800001	ONTONAGON	MI	2020	1,123	1,123	1
4800002	ONTONAGON	MI	2020	1,123	1,123	1
4800003	ONTONAGON	MI	2020	1,123	1,123	1
4800004	ONTONAGON	MI	2020	1,123	1,123	1
4800005	ONTONAGON	MI	2020	1,123	1,123	1
4800006	ONTONAGON	MI	2020	1,123	1,123	1
4800007	ONTONAGON	MI	2020	1,123	1,123	1
4800008	ONTONAGON	MI	2020	1,123	1,123	1
4800009	ONTONAGON	MI	2020	1,123	1,123	1
4800010	ONTONAGON	MI	2020	1,123	1,123	1
4800011	ONTONAGON	MI	2020	1,123	1,123	1
4800012	ONTONAGON	MI	2020	1,123	1,123	1
4800013	ONTONAGON	MI	2020	1,123	1,123	1
4800014	ONTONAGON	MI	2020	1,123	1,123	1
4800015	ONTONAGON	MI	2020	1,123	1,123	1
4800016	ONTONAGON	MI	2020	1,123	1,123	1
4800017	ONTONAGON	MI	2020	1,123	1,123	1
4800018	ONTONAGON	MI	2020	1,123	1,123	1
4800019	ONTONAGON	MI	2020	1,123	1,123	1
4800020	ONTONAGON	MI	2020	1,123	1,123	1

**LEGEND**

Water bodies: Blue lines and areas representing lakes, rivers, and streams.

Roads: Solid black lines for major roads, dashed black lines for minor roads.

Census Tract Boundaries: Thick black lines.

County Boundaries: Dotted black lines.

State Boundaries: Dashed black lines.

Other features: Green lines for specific tracts, red lines for other boundaries.

**Scale:** 1 inch = 10 miles

**North Arrow:** Points North.

**Metadata:** 2020 Census, Ontonagon County, Michigan. Date: 2020-08-20. File: 4800000-4800020.

**Sheet 1 of 1 (PAGE)**  
 TOWN: Sibley  
 COUNTY: Ontonagon  
 STATE: MI  
 YEAR: 2020

TYPE;FULLCODE;STATE;COUNTY;TRACT;SHEETS

TRACT;26131970100;26;131;9701.00;1

TRACT;26131970200;26;131;9702.00;1

TRACT;26131970300;26;131;9703.00;1

TRACT;26131990100;26;131;9901.00;1

2023 FFIEC Census Report - Summary Census Demographic Information

State: 26 - MICHIGAN (MI)

County: 131 - ONTONAGON COUNTY

Tract: All Tracts



State Code	County Code	Tract Code	Tract Income Level	Distressed or Underserved Tract	Tract Median Family Income %	2023 FFIEC Est. MSA/MD non-MSA/MD Median Family Income	2023 Est. Tract Median Family Income	2020 Tract Median Family Income	Tract Population	Tract Minority %	Minority Population	Owner Occupied Units	1- to 4- Family Units
26	131	9701.00	Middle	Yes*	84.14	\$79,800	\$67,144	\$54,667	1611	5.83	94	718	1876
26	131	9702.00	Middle	Yes*	84.93	\$79,800	\$67,774	\$55,179	2431	6.83	166	979	1796
26	131	9703.00	Moderate	No	71.80	\$79,800	\$57,296	\$46,648	1774	6.88	122	792	1910
26	131	9901.00	Unknown	No	0.00	\$79,800	\$0	\$0	0	0.00	0	0	0
26	131	9999.99	Middle	No	81.30	\$79,800	\$64,877	\$52,820	5816	6.57	382	2489	5582

\* Will automatically be included in the 2024 Distressed or Underserved Tract List

2023 FFIEC Census Report - Summary Census Income Information

State: 26 - MICHIGAN (MI)

County: 131 - ONTONAGON COUNTY

Tract: All Tracts



State Code	County Code	Tract Code	Tract Income Level	2020 MSA/MD Statewide non-MSA/MD Median Family Income	2023 FFIEC Est. MSA/MD non-MSA/MD Median Family Income	% Below Poverty Line	Tract Median Family Income %	2020 Tract Median Family Income	2023 Est. Tract Median Family Income	2020 Tract Median Household Income
26	131	9701.00	Middle	\$64,965	\$79,800	16.12	84.14	\$54,667	\$67,144	\$42,043
26	131	9702.00	Middle	\$64,965	\$79,800	15.57	84.93	\$55,179	\$67,774	\$42,895
26	131	9703.00	Moderate	\$64,965	\$79,800	16.58	71.80	\$46,648	\$57,296	\$40,179
26	131	9901.00	Unknown	\$64,965	\$79,800	0.00	0.00	\$0	\$0	\$0
26	131	9999.99	Middle	\$64,965	\$79,800	16.03	81.30	\$52,820	\$64,877	\$41,776



2023 FFIEC Census Report - Summary Census Population Information

State: 26 - MICHIGAN (MI)

County: 131 - ONTONAGON COUNTY

Tract: All Tracts



State Code	County Code	Tract Code	Tract Population	Tract Minority %	Number of Families	Number of Households	Non-Hisp White Population	Tract Minority Population	American Indian Population	Asian/Hawaiian/Pacific Islander Population	Black Population	Hispanic Population	Other Population/Two or More Races
26	131	9701.00	1611	5.83	496	801	1517	94	21	5	2	17	49
26	131	9702.00	2431	6.83	660	1166	2265	166	8	11	2	33	112
26	131	9703.00	1774	6.88	573	856	1652	122	31	6	4	18	63
26	131	9901.00	0	0.00	0	0	0	0	0	0	0	0	0
26	131	9999.99	5816	6.57	1729	2823	5434	382	60	22	8	68	224

2023 FFIEC Census Report - Summary Census Housing Information

State: 26 - MICHIGAN (MI)

County: 131 - ONTONAGON COUNTY

Tract: All Tracts



State Code	County Code	Tract Code	Total Housing Units	1- to 4-Family Units	Median House Age (Years)	Inside Principal City?	Owner Occupied Units	Vacant Units	Owner Occupied 1- to 4-Family Units	Renter Occupied Units
26	131	9701.00	1893	1876	50	No	718	1092	718	83
26	131	9702.00	1851	1796	74	No	979	685	979	187
26	131	9703.00	1959	1910	51	No	792	1103	792	64
26	131	9901.00	0	0	0	No	0	0	0	0
26	131	9999.99	5703	5582	58	No	2489	2880	2489	334

**IRON  
COUNTY,  
WISCONSIN**

Iron County, Wisconsin

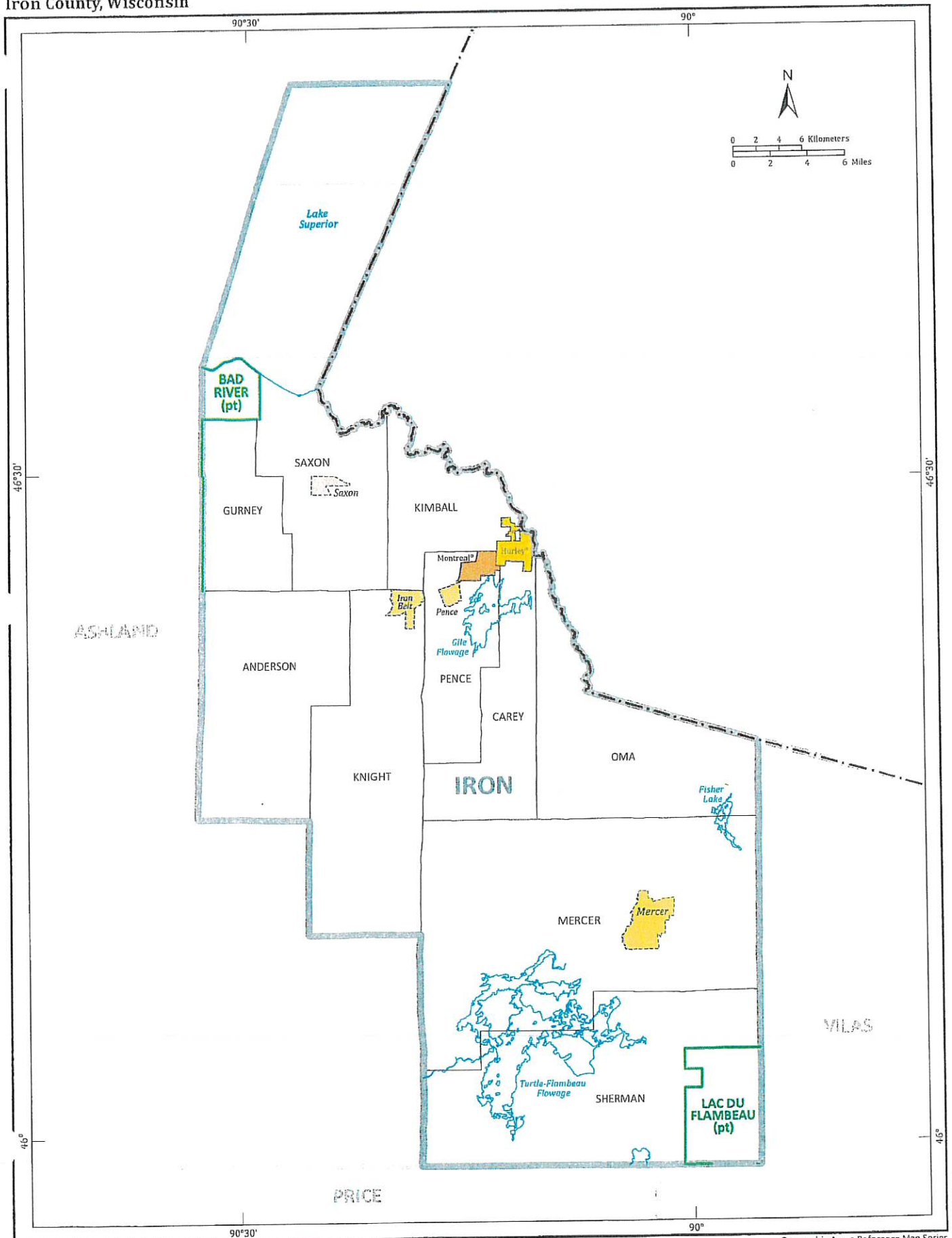

2020 CENSUS - CENSUS TRACT REFERENCE MAP- Iron County, WI

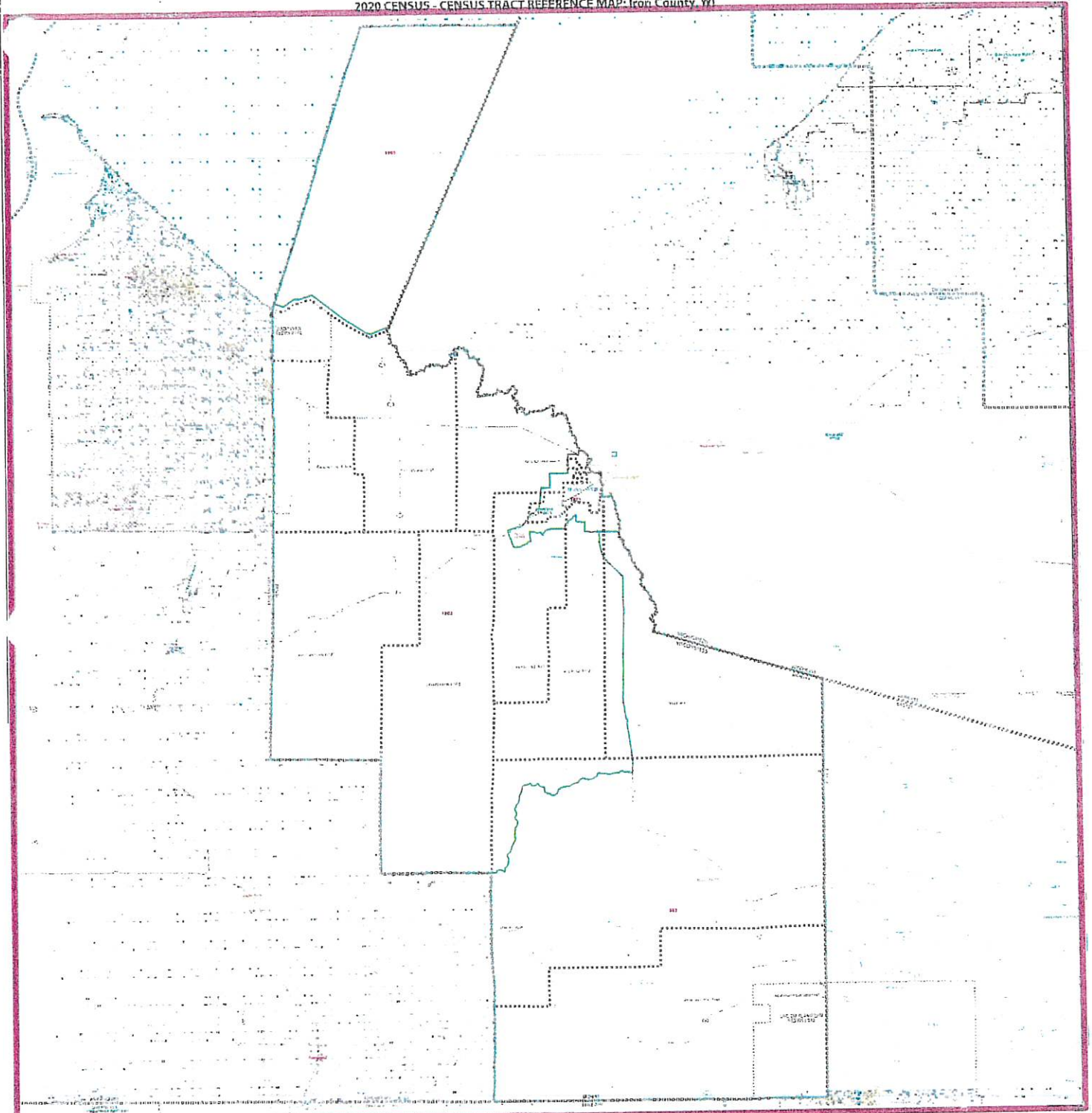

Legend	Symbol	Label	Legend	Symbol	Label
Water	Blue	Water	Water	Blue	Water
Major Road	Thick Dashed Line	Major Road	Major Road	Thick Dashed Line	Major Road
Minor Road	Thin Dashed Line	Minor Road	Minor Road	Thin Dashed Line	Minor Road
County Boundary	Red Dashed Line	County Boundary	County Boundary	Red Dashed Line	County Boundary
Census Tract Boundary	Black Dashed Line	Census Tract Boundary	Census Tract Boundary	Black Dashed Line	Census Tract Boundary
Water	Blue	Water	Water	Blue	Water
Major Road	Thick Dashed Line	Major Road	Major Road	Thick Dashed Line	Major Road
Minor Road	Thin Dashed Line	Minor Road	Minor Road	Thin Dashed Line	Minor Road
County Boundary	Red Dashed Line	County Boundary	County Boundary	Red Dashed Line	County Boundary
Census Tract Boundary	Black Dashed Line	Census Tract Boundary	Census Tract Boundary	Black Dashed Line	Census Tract Boundary

Map of Wisconsin and Iron County, WI, showing the location of Iron County, WI, and the location of the map. The map is a reference map for the 2020 Census. It shows the boundaries of the census tracts in Iron County, WI. The map is a reference map for the 2020 Census. It shows the boundaries of the census tracts in Iron County, WI. The map is a reference map for the 2020 Census. It shows the boundaries of the census tracts in Iron County, WI.

Map of Wisconsin and Iron County, WI, showing the location of Iron County, WI, and the location of the map. The map is a reference map for the 2020 Census. It shows the boundaries of the census tracts in Iron County, WI. The map is a reference map for the 2020 Census. It shows the boundaries of the census tracts in Iron County, WI. The map is a reference map for the 2020 Census. It shows the boundaries of the census tracts in Iron County, WI.

Map of Wisconsin and Iron County, WI, showing the location of Iron County, WI, and the location of the map. The map is a reference map for the 2020 Census. It shows the boundaries of the census tracts in Iron County, WI. The map is a reference map for the 2020 Census. It shows the boundaries of the census tracts in Iron County, WI. The map is a reference map for the 2020 Census. It shows the boundaries of the census tracts in Iron County, WI.

TYPE;FULLCODE;STATE;COUNTY;TRACT;SHEETS  
TRACT;55051180100;55;051;1801.00;1  
TRACT;55051180200;55;051;1802.00;1  
TRACT;55051180300;55;051;1803.00;1  
TRACT;55051990000;55;051;9900.00;1

2023 FFIEC Census Report - Summary Census Demographic Information

State: 55 - WISCONSIN (WI)

County: 051 - IRON COUNTY

Tract: All Tracts



State Code	County Code	Tract Code	Tract Income Level	Distressed or Underserved Tract	Tract Median Family Income %	2023 FFIEC Est. MSA/MD non-MSA/MD Median Family Income	2023 Est. Tract Median Family Income	2020 Tract Median Family Income	Tract Population	Tract Minority %	Minority Population	Owner Occupied Units	1- to 4-Family Units
55	051	1801.00	Moderate	No	66.40	\$86,000	\$57,104	\$47,639	2616	5.96	156	821	1518
55	051	1802.00	Middle	Yes*	100.39	\$86,000	\$86,335	\$72,024	1352	5.25	71	575	1203
55	051	1803.00	Middle	Yes*	84.85	\$86,000	\$72,971	\$60,875	2169	4.66	101	867	3094
55	051	9900.00	Unknown	No	0.00	\$86,000	\$0	\$0	0	0.00	0	0	0
55	051	9999.99	Middle	No	80.44	\$86,000	\$69,178	\$57,708	6137	5.34	328	2263	5815

\* Will automatically be included in the 2024 Distressed or Underserved Tract List

2023 FFIEC Census Report - Summary Census Income Information  
 State: 55 - WISCONSIN (WI)  
 County: 051 - IRON COUNTY  
 Tract: All Tracts



State Code	County Code	Tract Code	Tract Income Level	2020 MSA/MD Statewide non-MSA/MD Median Family Income	2023 FFIEC Est. MSA/MD non-MSA/MD Median Family Income	% Below Poverty Line	Tract Median Family Income %	2020 Tract Median Family Income	2023 Est. Tract Median Family Income	2020 Tract Median Household Income
55	051	1801.00	Moderate	\$71,740	\$86,000	18.74	66.40	\$47,639	\$57,104	\$35,658
55	051	1802.00	Middle	\$71,740	\$86,000	9.94	100.39	\$72,024	\$86,335	\$56,771
55	051	1803.00	Middle	\$71,740	\$86,000	9.39	84.85	\$60,875	\$72,971	\$52,222
55	051	9900.00	Unknown	\$71,740	\$86,000	0.00	0.00	\$0	\$0	\$0
55	051	9999.99	Middle	\$71,740	\$86,000	13.39	80.44	\$57,708	\$69,178	\$45,588



2023 FFIEC Census Report - Summary Census Population Information  
 State: 55 - WISCONSIN (WI)  
 County: 051 - IRON COUNTY  
 Tract: All Tracts



State Code	County Code	Tract Code	Tract Population	Tract Minority %	Number of Families	Number of Households	Non-Hisp White Population	Tract Minority Population	American Indian Population	Asian/Hawaiian/Pacific Islander Population	Black Population	Hispanic Population	Other Population/Two or More Races
55	051	1801.00	2616	5.96	608	1210	2460	156	37	9	4	33	73
55	051	1802.00	1352	5.25	398	635	1281	71	8	0	3	14	46
55	051	1803.00	2169	4.66	627	1014	2068	101	18	4	4	25	50
55	051	9900.00	0	0.00	0	0	0	0	0	0	0	0	0
55	051	9999.99	6137	5.34	1633	2859	5809	328	63	13	11	72	169

2023 FFIEC Census Report - Summary Census Housing Information

State: 55 - WISCONSIN (WI)

County: 051 - IRON COUNTY

Tract: All Tracts



State Code	County Code	Tract Code	Total Housing Units	1- to 4-Family Units	Median House Age (Years)	Inside Principal City?	Owner Occupied Units	Vacant Units	Owner Occupied 1- to 4- Family Units	Renter Occupied Units
55	051	1801.00	1698	1518	71	No	821	488	817	389
55	051	1802.00	1227	1203	47	No	575	592	575	60
55	051	1803.00	3169	3094	40	No	867	2155	867	147
55	051	9900.00	0	0	0	No	0	0	0	0
55	051	9999.99	6094	5815	48	No	2263	3235	2259	596